



Product Information

Kytun roofline trims permanently secure slates on gable ends and give an attractive maintenance free finish to the rooflines. The trims are available in both aluminium and PVC.

All trims have an innovative patented drip system to prevent water causing damage

DESIGN

to the roof. All trims can be manufactured in aluminium and customised to your specification and are available in a range of colours including: Black, Blue / Black and Brown.

design :: noka.com



Email >> info@kytun.com
Web >> www.kytun.com

KYTUN SLATE TRIM RANGE

>>> [Product Service Information](#)

KYTUN Slate Trim Product Codes

CODE	DESCRIPTION	UNIT	PER PACK
C01	Standard Gable Trim (L)	3m	20
C02	Standard Gable Trim (R)	3m	9
C03	Exposing Roof Gable Trim	3m	20
C07	Slate Roof Valley Trim	3m	10

All products available in aluminium & PVC



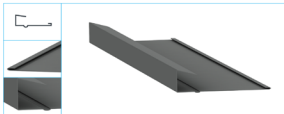

Standard Gable Slate Trim - Type 1

The Standard Gable Trim is installed in an identical manner to the Type 2 Slate Trim.

However, as the trim does not have the same supporting leg, no cutting is required to overlap the trims. Due to the absence of



this leg on the trim, it is advisable to put a bead of silicone between the trim and the top of the fascia board.

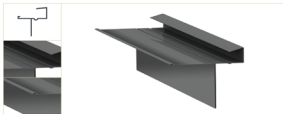

Standard Gable Slate Trim - Type 2

Starting at the base of the roofline, position the trim against the battens and secure it using 40mm galvannead nails.

The trim can be butted together or simply overlapped given the flexible properties of



the trims. A section of the leg should be cut off to allow for this overlap. The upper end of the trim is cut to the required length and angle before nailing to the battens.

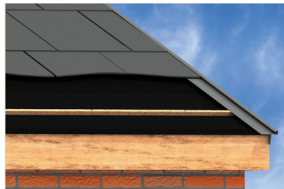

Standard Gable Slate Trim (Type 2) >> CONTEXT VIEW

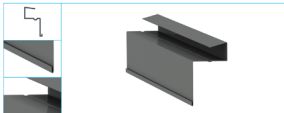

Existing Roof Slate Trim

This trim is ideal for roofs that slates have already been applied to.

It is installed by placing the trim over the edge of the slates and secured against the outside rafter board using 40mm galvannead



nails. It is installed in this fashion as the slates would be covering the battens on the roof for fixing.

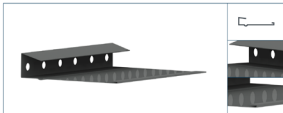

Slate Roof Valley Trim

A roof valley is the intersection between a dormer wall and roof surface, or possibly the intersection between two separate roofing systems. This Trim is specifically used for a roof valley. It secures to each batten and on top of the flashing using 40mm galvannead



nails. The Trims should be overlapped where they meet and be sealed with silicone.

Due to the high volume of water travelling down the valley a patented water drip and multiple outlet system runs along the trim.

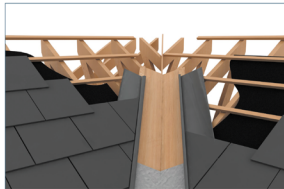

Slate Roof Valley Trim >> CONTEXT VIEW